



65TH ANNUAL CONFERENCE

October 24-27, 2010



TAX EXECUTIVES INSTITUTE, INC.

1200 G Street, N.W., Suite 300

Washington, D.C. 20005-3814

(P) 202.638.5601 | (F) 202.638.5607

www.tei.org

CHICAGO

Onsite Program

ILLINOIS

PRESIDENT'S LETTER

Friends,

Welcome to Chicago and to TEI's 65th Annual Conference. We very much appreciate the confidence you've shown in TEI's ability to provide you with the best in tax education and peer-to-peer networking. Combined with plenary sessions on Schedule UTP and a Washington Update, our two tracks of technical sessions will yield as many as 16.5 CPE credits for conference participants.

I am especially pleased that the following government officials will address the conference:

- Deputy Assistant Treasury Secretary Stephen Shay
- IRS Deputy Commissioner Steven Miller
- LB&I Commissioner Heather Maloy

The conference will also provide ample opportunity for networking, including our Monday industry sessions and social events hosted by TEI and our conference sponsors. You will also have the opportunity to visit exhibits staffed by the Institute's conference sponsors, as well to experience our Chicago Chapter's spectacular hospitality efforts. Finally, we'll all be able to honor former TEI Presidents Sol Coffino of San Francisco and Dave Bernard of Northeast Wisconsin.

Finally, please let us know how we can improve future conferences by filling out the conference evaluation form.



Paul O'Connor

TEI International President

GENERAL INFORMATION

CONFERENCE PARTICIPATION

You must register for the entire conference to attend any educational session or take part in any conference activity, including keynote addresses. Admission to luncheons, receptions, and the banquet will be by ticket only. Conference name badges will be required for admission to all educational sessions. No partial or split registration will be permitted.



Registrants are encouraged to visit exhibits staffed by TEI's conference sponsors, whose financial support enables the Institute to pursue its educational, networking, and advocacy goals without raising program fees or dues. Registrants should note that by entering drawings held by the sponsors, they are consenting to being contacted by the firms. In addition, TEI grants a one-time license to conference sponsors to contact registrants following the conference. Registrants wishing to have their names removed from the list provided to sponsors should write the word "remove" on the back of their business card and drop it off at the TEI Registration Desk. Questions about TEI's sponsorship program should be directed to asktei@tei.org. **Note:** Sponsors are not permitted to attend any technical sessions.

SPOUSES

The spouse fee covers the reception on Sunday; a brunch on Monday; the reception and banquet on Tuesday and Wednesday luncheon. A spouse hospitality suite will be open on Sunday where professional tour guides will assist in planning visits to area attractions.

CONFERENCE ATTIRE

Business or business casual attire may be worn during the day and on Sunday evening. Business attire is appropriate on Tuesday evening.

MEAL TICKETS

Registrants may purchase tickets for guests to luncheons, receptions, and the banquet at the TEI Registration Desk. Guest tickets may not be purchased for sponsors or practitioners.

SMOKING POLICY

Smoking is not permitted at any conference event.

GENERAL INFORMATION

MEDIA & MESSAGES

Sessions involving government officials will be open to the media. Telephone calls, messages, and conference announcements will be posted on the message board at the TEI Registration Desk. The phone number for messages is 312.464.1000 (ask for the TEI Registration Desk). Hotel guests may receive fax messages at 312.464.9140.

RECORDING DEVICES & CELLULAR PHONES

The use of tape and other recording devices is not permitted in any meeting rooms, except by accredited members of the media. To avoid disturbing others, please switch off mobile phones, email devices, and pagers upon entering the meeting room.

BANQUET TICKET EXCHANGE

The Tuesday banquet ticket included in your on-site registration packet must be exchanged for admission tickets at the ticket exchange desk adjacent to the TEI Registration Desk. A flyer explaining the ticket exchange and reserved table policy will be included in your registration packet.

SHIPPING OF CONFERENCE MATERIALS

Arrangements have been made with a full-service shipping company to ship registrants' conference materials to their offices at the conclusion of the conference. This service is at the individual's expense, and will include a boxing and handling charge. Registrants who do not wish to use this service should make shipping arrangements with the hotel business center or leave space in their luggage for transporting materials home.

CPE CREDIT INFORMATION

TEI is registered with the National Association of State Boards of Accountancy as a sponsor of "group live" continuing professional education on the National Registry of CPE Sponsors (registry number 103086). State boards of accountancy have final authority on the acceptance of individual courses. Complaints regarding sponsors may be addressed to NASBA, 150 Fourth Avenue North, Suite 2700, Nashville, TN 37219-2417. Website: www.nasba.org. For more information regarding administrative policies such as complaint and refund, call TEI at 202.638.5601.

Continuing education credits will be awarded on the following basis: 14 credit hours on a 60-minute hour, and 16.5 credit hours based on a 50-minute hour. CLE credits are also available for attending the conference and a breakdown of accounting and non-accounting hours will be available onsite. This is a group-live program.

Date: Annual Conference, October 24-27, 2010

Delivery Method: Group Live

GENERAL INFORMATION

CPE CREDIT INFORMATION (CONTINUED)

Program Level: Overview

Field of Study: Taxes

Learning Objectives: To provide updates on legislative, regulatory, and judicial developments relating to federal, state & local, international, and Canadian taxation, as well as to analyze the effect of financial reporting developments on effective operation for corporate tax departments.

Prerequisite: None.

Advanced Preparation: No advance preparation required.

CPE Credit: 16.5 hours

CLE Credit: 14 hours

Ethics Credit: 1 hour

Tax Executives Institute and TEI Education Fund accord to participants of any race, color, creed, sex, or national ethnic origin all the rights, privileges, programs, and activities generally accorded or made available to participants at its programs, courses, and other activities.

CPE/CLE requirements vary from jurisdiction to jurisdiction. TEI's education programs are designed to meet NASBA standards, and are generally accepted by CPE/CLE agencies across the United States. Registrants should check the rules in their own jurisdictions to ensure eligibility.



CONFERENCE SPONSORS

Tax Executives Institute acknowledges the support of the following sponsors of the 65th Annual Conference.

PLATINUM

Bingham McCutchen LLP

Deloitte & Touche LLP

Ernst & Young LLP

Grant Thornton LLP

KPMG LLP

Mayer Brown LLP

PricewaterhouseCoopers LLP

Sutherland Asbill & Brennan LLP

Thomson Reuters

Vertex, Inc.

ACKNOWLEDGMENTS

Tax Executives Institute and TEI Education Fund acknowledge the ongoing support of the Tax & Accounting business of **Thomson Reuters**, TEI's exclusive affinity partner for tax research. The Institute also thanks Thomson Reuters (ONESOURCE) for providing the tote bags for use by participants at the conference, and **McGladrey** for providing *Wall Street Journals*.

CONFERENCE SPONSORS

GOLD

ADP

Baker & McKenzie LLP

Ballentine Barbera Group

BDO USA, LLP

Bureau Van Dijk

Ceteris, Inc.

CORPTAX, Inc.

Crowe Horwath LLP

DuCharme, McMillen & Associates, Inc.

Duff & Phelps LLC

Fenwick & West LLP

Jefferson Wells

Longview Solutions

McDermott Will & Emery LLP

McGladrey

True Partners Consulting LLC

White & Case LLP

SILVER

Alston & Bird LLP

Baker Botts L.L.P.

Baker Hostetler

BNA Tax & Accounting

Covington & Burling LLP

Ivins, Phillips & Barker

Latham & Watkins LLP

Miller & Chevalier Chartered

Morgan Lewis & Bockius LLP

Pepper Hamilton LLP

Skadden, Arps, Slate, Meagher & Flom LLP

BRONZE

Chamberlain, Hrdlicka, White, Williams & Martin

Key: CB = Chicago Ballroom (Level 4)
SB = Sheraton Ballroom (Level 4)

Sunday October 24, 2010

- 8:30-11:30 am **Executive Committee Meeting** Colorado (Level 2)
- 10:00 am-8:00 pm **Registration** SB Promenade
- 11:30 am-1:00 pm **Executive Committee, Committee Chairs, and Past Presidents Luncheon** Missouri (Level 2)
- 1:00-4:00 pm **Board of Directors Meeting** CB 6
- 4:00-6:00 pm **Committee Meetings**
- Corporate Tax Mgt. Parlor B (Level 3)
 - Federal Tax Missouri (Level 2)
 - Financial Reporting Parlor F (Level 3)
 - International Tax Parlor C (Level 3)
 - IRS Admin Affairs Mississippi (Level 2)
 - State & Local Tax Parlor D (Level 3)
- 6:30-7:30 pm **Welcome Reception** CB 10

(ALL SESSIONS BEFORE 6:00 PM BY INVITATION ONLY)

Monday October 25, 2010

- 7:00 am-5:00 pm **Registration** SB Promenade
- 7:00-8:00 am **Continental Breakfast** SB 4
- 8:00-9:00 am **Welcome and Keynote Address** CB 6
- Presiding: Paul O'Connor
EMD Millipore
Billerica, Massachusetts
TEI International President
- Remarks by: Heather C. Maloy
Commissioner, Large Business & International Division
Internal Revenue Service
Washington, D.C.
- 9:00-10:00 am **PLENARY SESSION** CB 6
- Moderator: Donald J. Rath
Synopsis, Inc.
Mountain View, California
Chair, TEI's Financial Reporting Committee
- Schedule UTP**
- Michael J. Desmond
Bingham McCutchen LLP
Washington, D.C.
- George B. Forster
PricewaterhouseCoopers LLP
New York, New York
- 10:00-10:15 am **Refreshment Break** SB 4

Monday October 25, 2010

10:15-11:15 AM CONCURRENT SESSIONS

FEDERAL TAX CB 6

Moderators: Gary P. Hickman
Oldcastle, Inc.
Atlanta, Georgia
Vice Chair, TEI's Federal Tax Committee

David E. Sherwood
Microsoft Corporation
Redmond, Washington
Chair, TEI's Subcommittee on Employee Benefits & Payroll Taxes

Essentials of Health Care Reform for Tax Executives

C. Frederick Oliphant, III
Miller & Chevalier Chartered
Washington, D.C.

David A. Osterdorf
Towers Watson & Co.
Milwaukee, Wisconsin

STATE & LOCAL TAX SB 5

Moderator: Cathleen Stevens
Brunswick Corporation
Lake Forest, Illinois

State & Local Tax Update: New Legislation, Key Cases & More

Ann L. Holley
KPMG LLP
Washington, D.C.

Kendall L. Houghton
Baker & McKenzie LLP
Washington, D.C.

11:15-11:30 am Refreshment Break SB 4

11:30 AM-12:30 PM CONCURRENT SESSIONS

IRS ADMINISTRATIVE AFFAIRS CB 6

Moderator: Mark C. Silbiger
The Lubrizol Company
Wickliffe, Ohio
Chair, TEI's IRS Administrative Affairs Committee

Rollout of the Revised Quality Examination Process

Patricia C. Chaback
Director, Communications, Technology & Media
Large Business & International Division
Internal Revenue Service
Oakland, California

Thomas L. Kittle-Kamp
Mayer Brown LLP
Chicago, Illinois

Monday

October 25, 2010

INTERNATIONAL TAX SB 5

Moderator: Janice L. Lucchesi
Akzo Nobel, Inc.
Chicago, Illinois

A Primer for Inversions: Responding to Your CFO

Nicholas J. DeNovio
Latham & Watkins LLP
Washington, D.C.

12:45-2:15 pm Luncheon Program CB 10

Presiding: Paul O'Connor
EMD Millipore
Billerica, Massachusetts
TEI International President

Remarks by: Steven T. Miller
Deputy Commissioner
(Services & Enforcement)
Internal Revenue Service
Washington, D.C.

2:30-5:00 pm **Industry Sessions** (see pages 26-27 for listings)

5:00-6:00 pm **New Member & First-Time Conference Attendee Reception** (by invitation only) Java East (Level 3)

New TEI members and other first-time conference attendees are invited to attend a social networking reception with members of TEI's Board of Directors.

Tuesday

October 26, 2010

7:00 am-5:00 pm **Registration** SB Promenade

7:00-8:00 am **Continental Breakfast** SB 4

7:00-8:00 am **CTO Breakfast** Michigan B (Level 2)

8:00-9:00 am **Keynote Address** CB 6

Presiding: Paul O'Connor
EMD Millipore
Billerica, Massachusetts
TEI International President

Remarks by: Stephen E. Shay
Deputy Assistant Treasury Secretary
for International Affairs
U.S. Department of the Treasury
Washington, D.C.

9:00-10:00 am **PLENARY SESSION** CB 6

Moderator: Paul O'Connor
EMD Millipore
Billerica, Massachusetts
TEI International President

Tuesday

October 26, 2010

Washington Update

Lester D. Ezrati
Hewlett-Packard Company
Palo Alto, California

Nicholas P. Giordano
Washington Council
Ernst & Young LLP
Washington, D.C.

David P. Lewis
Eli Lilly & Company
Indianapolis, Indiana

10:00-10:15 am **Refreshment Break** SB 4

10:15-11:15 AM CONCURRENT SESSIONS

FEDERAL TAX CB 6

Moderators: Robert L. Howren
BlueInx Corporation
Atlanta, Georgia
Vice Chair, TEI's Federal Tax Committee

John P. Orr, Jr.
Equinox
New York, New York
Vice Chair, TEI's Federal Tax Committee

Winning with Accounting Methods: Blocking, Tackling & Innovative Game Plans

C. Ellen MacNeil
Deloitte Tax LLP
Washington, D.C.

Michael Ulleweit
Deloitte Tax LLP
Chicago, Illinois

CANADIAN INCOME TAX SB 5

Moderator: Carmine A. Arcari
Royal Bank of Canada
Toronto, Ontario
Chair, TEI's Canadian Income Tax Committee

Structuring Investments & Acquisitions in Canada

- Definition of Taxable Canadian Property
- Recent Canada-U.S. Tax Treaty Issues, including Treatment of Hybrid Entities, Canada's Application of the Limitation on Benefits & Deemed Services PE
- Cash Repatriation/Redeployment Strategies
- Administrative, Judicial & Legislative Developments

Joseph T. Realmuto
PricewaterhouseCoopers LLP
Boston, Massachusetts

Janice Russell
PricewaterhouseCoopers LLP
Toronto, Ontario

11:15-11:30 am **Refreshment Break** SB 4

11:30 AM-12:30 PM CONCURRENT SESSIONS

INTERNATIONAL TAX SB 5

Moderator: Daniel R. Goff
Xilinx, Inc.
San Jose, California
Chair, TEI's International Tax Committee

Latin America Update

Simone Dias Musa
Trench, Rossi e Watanabe
São Paulo, Brazil

Ronald E. Evans
Baker & McKenzie S.C.
Caracas, Venezuela

John A. McLees
Baker & McKenzie LLP
Chicago, Illinois

Hector Reyes Freaner
Baker & McKenzie LLP
Mexico City, Mexico

STATE & LOCAL TAX CB 6

Moderator: Karen Boyaris
Aon Corporation
Glenview, Illinois
Vice Chair, TEI's State & Local Tax Committee

Dangers of Unreliable Intercompany Accounting: Issues in State Taxes

Pilar Mata
Sutherland Asbill & Brennan LLP
Washington, D.C.

Giles B. Sutton
Grant Thornton LLP
Charlotte, North Carolina

Eric S. Tresh
Sutherland Asbill & Brennan LLP
Atlanta, Georgia

12:45-2:15 pm **Luncheon Program** CB 10

Presiding: Paul O'Connor
EMD Millipore
Billerica, Massachusetts
TEI International President

Remarks by: Richard D. Pomp
University of Connecticut School of Law
Hartford, Connecticut

Professor Pomp served as Director of the New York Tax Study Commission and a member of the California Commission on the 21st Century Economy, and is Chairman of the Board of the Institute on Taxation and Economic Policy.

2:30-3:30 PM CONCURRENT SESSIONS

IRS ADMINISTRATIVE AFFAIRS CB 6

Moderator: Ernest N. Gates
Wal-Mart Stores, Inc.
Bentonville, Arkansas
Vice Chair, TEI's IRS Administrative Affairs Committee

IRS Currency Initiatives

- CAP
- Fast Track
- Early Referral

Elizabeth A. Erickson
McDermott Will & Emery LLP
Washington, D.C.

INTERNATIONAL TAX SB 5

Moderator: Daniel J. Wenzel
S.C. Johnson & Son, Inc.
Racine, Wisconsin
Vice Chair, TEI's International Tax Committee

OECD Developments

- Distinguishing Intangibles from Services
- Transfer Pricing

David M. Ernick
Associate International Tax Counsel
U.S. Department of the Treasury
Washington, D.C.

Larry R. Langdon
Mayer Brown LLP
Palo Alto, California

3:30-4:00 pm **Refreshment Break** SB 4

4:00-5:00 PM CONCURRENT SESSIONS

FEDERAL TAX CB 6

Moderators: Philip G. Cohen
Unilever United States, Inc.
Englewood Cliffs, New Jersey
Chair, TEI's Federal Subcommittee on Financial Products

Key: CB = Chicago Ballroom (Level 4)
SB = Sheraton Ballroom (Level 4)

Wednesday October 27, 2010

Tuesday October 26, 2010

John A. Mann
Walgreen Co.
Deerfield, Illinois
Chair, TEI's Federal Tax Committee

Applying the Codified Economic Substance Rule: A Transactional Approach

Mark J. Silverman
Step toe & Johnson LLP
Washington, D.C.

Lisa M. Zarlenga
Step toe & Johnson LLP
Washington, D.C.

STATE & LOCAL TAX SB 5

Moderator: Tov B. Hauelsen
General Electric Company
Stamford, Connecticut

Effects of Bringing Foreign Entities into a Combined Return

Nicole Crighton
KPMG LLP
New York, New York

Gianluca A.D. Pitetti
KPMG LLP
Chicago, Illinois

Kimberly M. Reeder
Morgan Lewis & Bockius LLP
Palo Alto, California

5:00-6:00 pm **CAP Companies** Michigan B (Level 2)
(by invitation only)

6:30-7:30 pm **Reception** CB 10

7:30-10:30 pm **Banquet** CB 6

Presiding: Paul O'Connor
EMD Millipore
Billerica, Massachusetts
TEI International President

Presentation: Honorary Memberships

David L. Bernard
Northeast Wisconsin Chapter

Sol Coffino
San Francisco Chapter

Recognition

Mary Lou Fahey
TEI General Counsel

Entertainment: **Second City**

7:00-8:30 am **Thomson Reuters Tax & Accounting — Corporate Software & Services Advisory Board**
(by invitation only) Michigan B (Level 2)

7:00-8:30 am **Thomson Reuters Tax & Accounting — Research & Guidance Advisory Board**
(by invitation only) Michigan A (Level 2)

7:30 am-1:00 pm **Registration** SB Promenade

7:30-8:30 am **Continental Breakfast** SB 4

7:30 am-1:00 pm **Conference Material Shipping** CB Promenade

8:30-9:30 AM CONCURRENT SESSIONS

CORPORATE TAX MANAGEMENT/ FEDERAL TAX CB 6

Moderators: Philip G. Cohen
Unilever United States, Inc.
Englewood Cliffs, New Jersey
Chair, TEI's Federal Subcommittee on Financial Products

David H. Fine
Apache Corporation
Houston, Texas
Chair, TEI's Corporate Tax Management Committee

Ethical Considerations for In-House Tax Executives

Gerald A. Kafka
Latham & Watkins LLP
Washington, D.C.

CANADIAN COMMODITY TAX SB 5

Moderator: Rodney C. Bergen
The Jim Pattison Group
Vancouver, British Columbia
TEI's Vice President for Canadian Affairs

Update on Commodity Tax Issues and Financial Services

David Schlesinger
KPMG LLP
Toronto, Ontario

9:30-9:45 pm **Refreshment Break** SB 4

Key: CB = Chicago Ballroom (Level 4)
SB = Sheraton Ballroom (Level 4)

Wednesday October 27, 2010

Wednesday

October 27, 2010

11:00 AM-NOON CONCURRENT SESSIONS

9:45-10:45 AM CONCURRENT SESSIONS

FEDERAL TAX CB 6

Moderators: Gary P. Hickman
Oldcastle, Inc.
Atlanta, Georgia
Vice Chair, TEI's Federal Tax Committee

John A. Mann
Walgreen Co.
Deerfield, Illinois
Chair, TEI's Federal Tax Committee

Partnership/Joint Venture Update

- Recent Transactions, Structures & Planning
- Guidance Developments, Including Proposed Carried Interest Legislation
- IRS Audit Issues and Activity

Glenn E. Dance
Ernst & Young LLP
Washington, D.C.

Jeffrey A. Erickson
Ernst & Young LLP
Washington, D.C.

STATE & LOCAL TAX SB 5

Moderator: Mitchell E. Salamon
American Airlines
Fort Worth, Texas

State Transaction Taxes: Making the Transaction Tax Process More Efficient

Thomas H. Donohoe
McDermott Will & Emery LLP
Chicago, Illinois

Ralph D. Gilman
PricewaterhouseCoopers LLP
Chicago, Illinois

Karen L. Warner
Deloitte & Touche LLP
Dallas, Texas

10:45-11:00 am **Refreshment Break** SB 4

FINANCIAL REPORTING CB 6

Moderator: Donald J. Rath
Synopsis, Inc.
Mountain View, California
Chair, TEI's Financial Reporting Committee

A View from Within — An Internal Auditor's Perspective on the Tax Department

Michael Goetter
Navistar International Corp.
Warrenville, Illinois

Allen M. Shoulders
Ernst & Young LLP
Dallas, Texas

INTERNATIONAL TAX SB 5

Moderator: Dorothy C. Chao
Baxter International, Inc.
Deerfield, Illinois
Vice Chair, TEI's International Tax Committee

Treasury Centers: Key Issues to Consider

Amy C. Black
The Procter & Gamble Company
Cincinnati, Ohio

T. Timothy Tuerff
Deloitte Tax LLP
Washington, D.C.

Noon-1:00 pm **Box Lunch (No Speaker)** SB 4

Noon-1:00 pm **Continuing Education Committee Meeting** Michigan B (Level 2)

INDUSTRY SESSIONS

Industry sessions identified as being “self moderated” currently have no moderator to prepare the agenda and guide the discussion. Evaluations show that moderated sessions are more beneficial to the group. If you would like to find out more about being an industry session moderator, or to volunteer, please contact meetings@tei.org.

Aerospace & Government Contracting Tavin D. Skoff SAIC	Parlor D (Level 3)
C. Vincent Quella SAIC	
Automotive Suppliers/Machinery & Allied Products Session will be self-moderated.	Michigan A (Level 2)
Chemicals Kenneth M. Bittner Evonik Degussa Corporation	Parlor A (Level 3)
Electronics Michael J. Bernard Microsoft Corporation	Michigan B (Level 2)
William B. Blaylock Texas Instruments, Inc.	
Financial Institutions Session will be self-moderated.	Columbus B (Level 3)
Food & Beverage Zoltan M. Eszes Miller Brewing Company	SB 1
Forest Products Sheri T. Dunn Weyerhaeuser Company	Columbus A (Level 3)
Dwayne Tofell Potlatch Corporation	
Health Care Janet L. Kreilein Extencicare Health Services, Inc.	Lincoln Boardroom (Level 3)
Susan Sexton HCR Manor Care, Inc.	
Insurance Bruce R. Thompson Nationwide Insurance Company	Parlor G (Level 3)
Media C. Burt Duren Rodale, Inc.	Parlor B (Level 3)

INDUSTRY SESSIONS

Key: CB = Chicago Ballroom (Level 4)
SB = Sheraton Ballroom (Level 4)

Mining Session will be self-moderated.	Parlor E (Level 3)
Petroleum Mickey G. Culpepper Baker Hughes Inc.	Mississippi (Level 2)
Pharmaceuticals Anthony O'Donnell EMD Serono, Inc.	Mayfair (Level 2)
Primary Metals & Other Basic Manufacturing Katherine C. Castillo Guardian Industries Corporation	Arkansas (Level 2)
Restaurant, Hotel & Franchise Operations Mary J. Rentschler Domino's Pizza LLC	Colorado (Level 2)
Retail Trade Nancy C. Farahmand J.C. Penney Company, Inc.	Missouri (Level 2)
John P. Orr, Jr. Equinox	
Telecommunications David D. Gillman Telephone and Data Systems, Inc.	Parlor F (Level 3)
Transportation David C. Price Norfolk Southern Company	Parlor C (Level 3)
Utilities Session will be self-moderated.	Ohio (Level 2)
All Others - Manufacturing Robert M. Ahonen The Babcock & Wilcox Company	SB 2
Mark C. Silbiger The Lubrizol Corporation	
All Others - Non-Manufacturing Keith Janning The Hillman Group, Inc.	Erie (Level 2)
Michael J. Nesbitt Paychex, Inc.	

THANK YOU FROM TEI'S CHICAGO CHAPTER

The Chicago Chapter of Tax Executives Institute expresses its appreciation to the following firms for their contributions to the chapter's hospitality efforts at the Institute's 65th Annual Conference.

Abbott Laboratories
 Accenture, Ltd.
 Akzo Nobel Inc.
 Archer Daniels Midland Company
 Baker & McKenzie LLP
 Brunswick Corporation
 Caterpillar Inc.
 Corn Products International
 Deloitte & Touche LLP
 DuCharme, McMillen & Associates, Inc.
 Ernst & Young LLP
 GATX Corporation
 Grant Thornton LLP
 Horwood Marcus & Berk Chartered
 HSBC North America
 Hub Group, Inc.
 Huron Consulting Group
 Hyatt Corporation
 Jones Lang LaSalle Inc.
 Joy Global Inc.
 KPMG LLP
 Kraft Foods Inc.
 Kroeschell, Inc.
 Mayer Brown LLP
 McDermott Will & Emery LLP
 McDonald's Corporation
 Merisant Company
 Molex Inc.
 Navistar International Corp.
 PepsiCo, Inc.
 PricewaterhouseCoopers LLP
 R&M Consulting LLC
 Robert Bosch North America Tax Department
 Schneider Electric
 SIRVA, Inc.
 Skidmore, Owings & Merrill LLP
 State Farm Mutual Auto Insurance Company
 Takeda Pharmaceuticals North America, Inc.
 USG Corporation
 Walgreen Co.
 Wm. Wrigley Jr. Company
 WTAS LLC

MERITORIOUS SERVICE AWARDS



Recognizing that the success of Tax Executives Institute in advancing its educational, networking, and advocacy goals depends on the volunteer efforts of its members, TEI's Board of Directors created two meritorious service awards — one for Chapters and the other for Institute committees. Awards are given not only for work on particular projects, but also for sustained contributions. Listed below are the **2009-2010** recipients of these awards.

COMMITTEE

Canadian Income Tax	Monika M. Siegmund
Federal Tax	Philip G. Cohen
IRS Administrative Affairs	Christopher T. Riley
State & Local Tax	Victor Ledesma

CHAPTER

Atlanta	Dan L. Lockridge
Chicago	Dorothy C. Chao
Minnesota	Don Stiles
Montreal	Daniel Ethier
New York	Joshua Wind
Philadelphia	Michael J. McGoldrick
San Francisco	Sol Coffino
Santa Clara Valley	Nanci S. Palmintere
Virginia	Joseph A. Hopkins

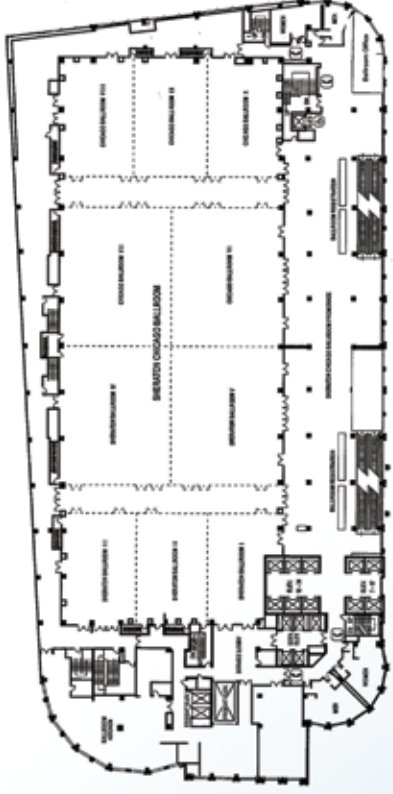

Level 4

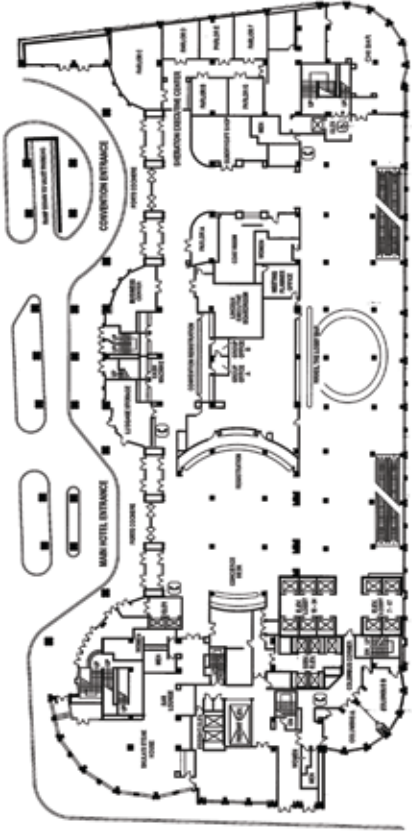

Level 3

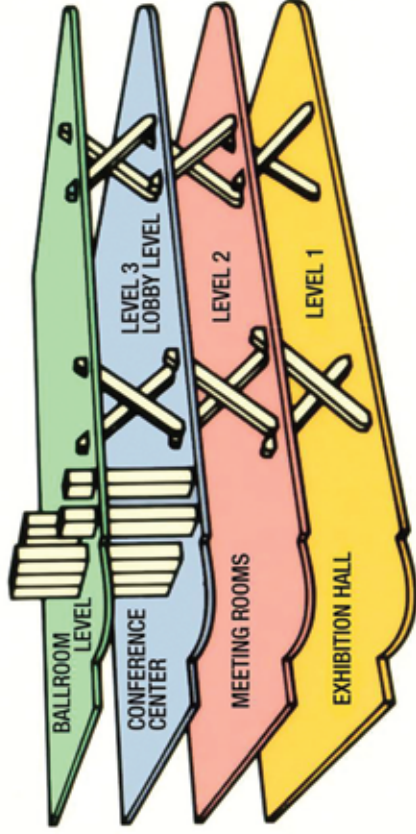

Sheraton Chicago Hotel Floor Plans

Level 2



Level 1

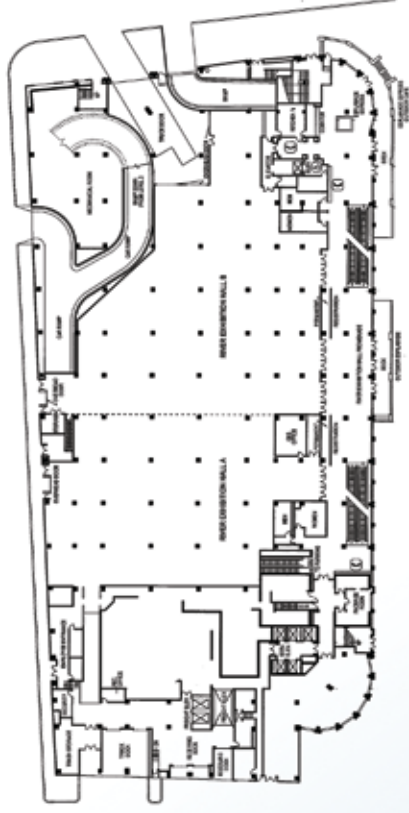



TAX EXECUTIVES INSTITUTE, INC.

CONGRATULATES

Sol Coffino

of the San Francisco Chapter
(1982-1983 International President)

and

David L. Bernard

of the Northeast Wisconsin Chapter
(2006-2007 International President)

On becoming

Honorary Members of the Institute

and

THANKS

Mary Lou Fahey

General Counsel

On her

22 Years of Service to TEI!

TEI CALENDAR OF EVENTS

2010

November 18-19* **Consolidated Returns Seminar**
(Marriott Solana (DFW) — Fort Worth, TX)

2011

February 22-24* **IRS Audits and Appeals Seminar**
(Hyatt Regency Orlando Airport — Orlando, FL)

April 3-6* **61st Midyear Conference**
(Grand Hyatt Washington — Washington, D.C.)

May 2-6* **Federal Tax Course – Level I**
(Michigan State University — East Lansing, MI)

June **International Tax Seminar**
Location TBD

June 26-28 **Leadership Seminar**
Location TBD

July 10-15* **International Tax Course**
(Georgia Tech Conference Center — Atlanta, GA)

August 7-9 **Annual Meeting of Members**
Location TBD

August 14-19* **Federal Tax Course – Level II**
(The Broadmoor — Colorado Springs, CO)

September **Financial Reporting Seminar**
Location TBD

Oct. 30-Nov. 2* **66th Annual Conference**
(Marriott Marquis — San Francisco, CA)

***Time and location fixed.**

Please check www.tei.org for updated information.